

Honda civic power not going windows

- Disconnect the 20P connector (A) from the master switch (B).
- Inspect the connector and socket terminals to be sure they are all making good contact.
 - If the terminals are bent, loose or corroded, repair them as necessary, and recheck the system.
 - If the terminals look OK, make the following input tests at the connector.
 - If a test indicates a problem, find and correct the cause, then recheck the system.
- If all the input tests prove OK, the power window master switch must be faulty; replace it.

With the connector still disconnected, make these input tests at the connector.

Next Page

Cavity	Wire	Test condition	Test: Desired result	Possible cause if result is not obtained
20	ORN	Connect the No. 14 to the No. 6 terminals, and the No. 4 to the No. 7 terminals, then turn the ignition switch ON (II).	Check for voltage between the No. 20 and No. 4 terminals: About 6 V should be indicated with the driver's window motor running.	Faulty driver's window motor. Refer to the driver's window motor pulser test.
4	BLK			An open in the wire
4	BLK	Under all conditions with main switch ON	Check for voltage to ground: There should be less than 1 V.	Poor ground (G501)
8				An open in the wire
14	GRN/WHT	Ignition switch ON (II)	Check for voltage to ground: There should be battery voltage.	Blown No. 23, 22, 24 or 25 (20 A) fuse in the under-dash fuse/relay box
2	GRN/BLK			Faulty power window relay

18 YEL/RED

An open in the wire

11 YEL/BLU

Blown No. 6 (7.5 A) fuse in the underdash fuse/relay box

Poor ground (G301)

Disconnect the 20P connector and make these input tests.

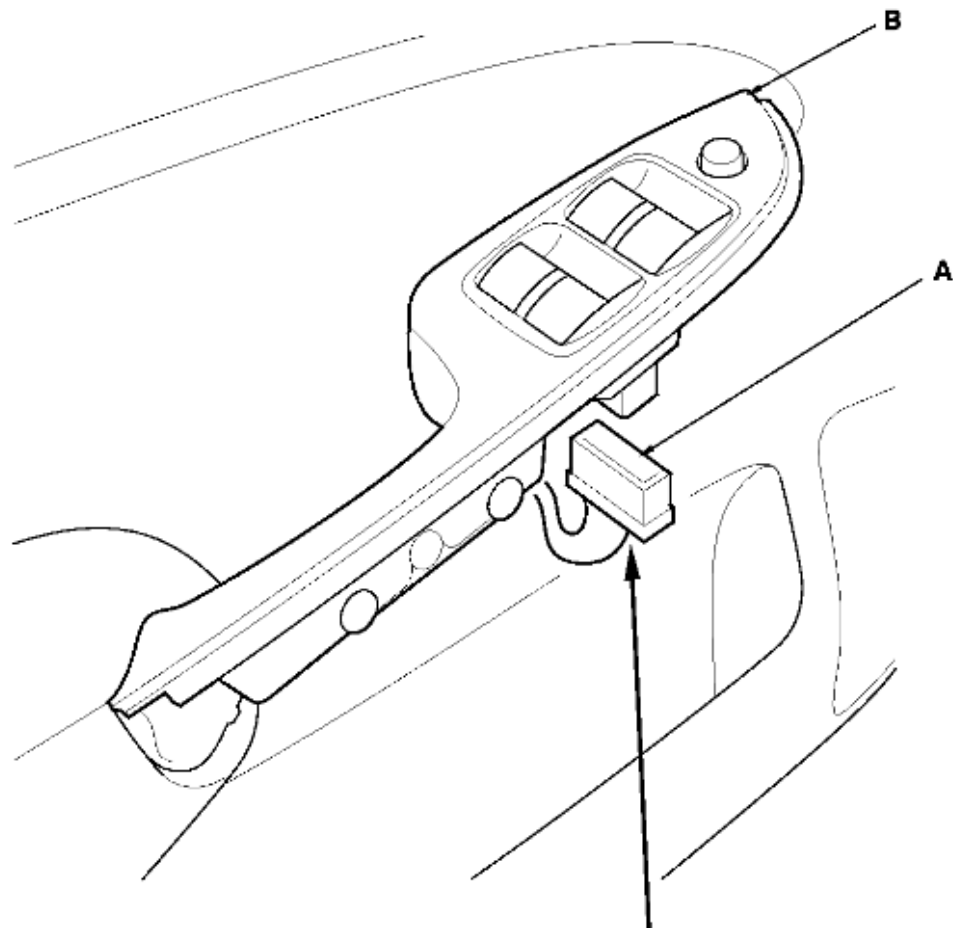

20 Pin Connector

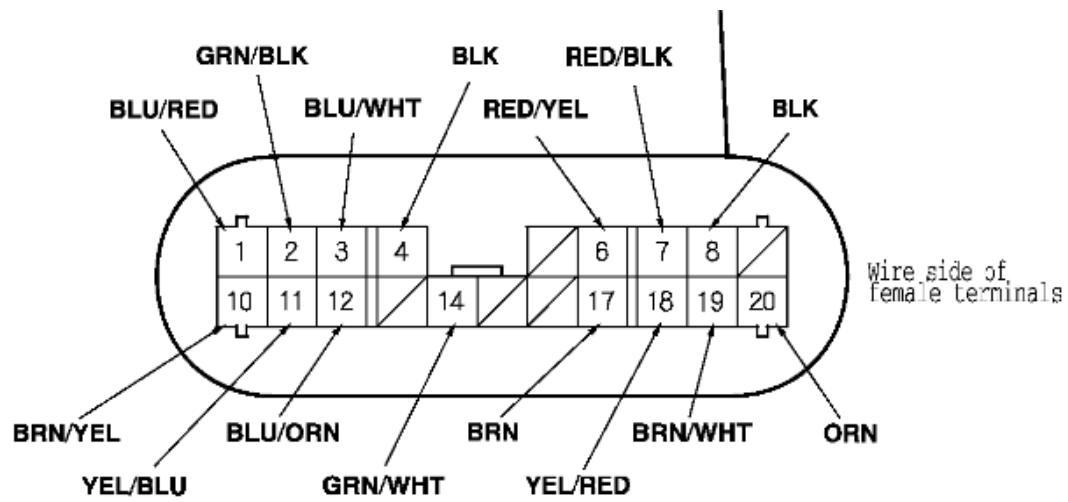

Cavity	Wire	Test condition	Test: Desired result	Possible cause if result is not obtained
6	RED/YEL	Connect the No. 14 to the No. 6 terminals, and the No. 7 to the No. 4 terminals, then turn the ignition switch ON (II).	Check for driver's window motor operation: It should run (the driver's window moves down).	Faulty driver's window motor
7	RED/BLK			An open in the wire
1	BLU/RED	Connect the No. 2 to the No. 3 terminals, and the No. 1 to the No. 8 terminals, then turn the ignition switch ON (II).	Check for front passenger's window motor operation: It should run (the front passenger's window moves down).	Faulty front passenger's window motor
3	BLU/WHT			Faulty front passenger's window switch
				An open in the wire
19	BRN/WHT	Connect the No. 18 to the No. 17 terminals, and the No. 19 to the No. 8 terminals, then turn the ignition switch ON (II).	Check for left rear window motor operation: It should run (the left rear window moves down).	Faulty left rear window motor

17 BRN

Faulty left rear window switch

An open in the wire

12 BLU/ORN Connect the No. 11 to the No. 10 terminals, and the No. 12 to the No. 8 terminals, then turn the ignition switch ON (II).

Check for right rear window motor operation:

It should run (the right rear window moves down).

Faulty right rear window motor

10 BRN/YEL

Faulty right rear window switch

An open in the wire

Disconnect the 20P connector and make these input tests.