

# SECURITY SYSTEM

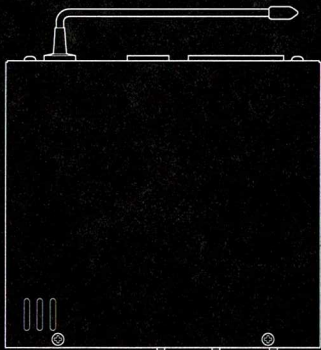

P / N : 08E51-ST7-200

REF. NO. : HS-5A

Please write the serial numbers of the remote control and the main unit below. Keep this booklet as a record of your purchase.

Remote Control No. : \_\_\_\_\_ Main Unit No. : \_\_\_\_\_

**ACURA**

# TABLE OF CONTENTS

<b>I. INTRODUCTION</b> .....	4
<b>II. FEATURES</b> .....	6
<b>III. REMOTE CONTROL TRANSMITTER</b>	
1. Controls .....	7
2. Signal Indicator LED .....	8
3. Battery Replacement .....	9
4. Precautions .....	10
<b>IV. SYSTEM CONTROLS</b>	
1. Control Panel .....	11
2. Disarm/Valet Switch .....	13
3. Glass Breakage Detector .....	13
4. Glass Breakage Detector Sensitivity Control .....	14
<b>V. ARMING</b>	
1. Manual (Remote Controlled) Arming .....	15
2. Automatic (Passive) Arming .....	16
3. Auto Lock Arming .....	17
<b>VI. DISARMING</b>	
1. Manual (Remote Controlled) Disarming .....	20
2. Disarm/Valet Switch Disarming .....	22

<b>VII. PANIC</b> .....	23
<b>VIII. VALET</b> .....	24
<b>IX. TRIPPED SENSOR WARNING &amp; INDICATION</b>	
1. Tripped Sensor Warning .....	25
2. Tripped Sensor Indication .....	25
3. Tripped Sensor Re-indication .....	27
4. Tripped Sensor Recall .....	27
<b>X. GLOSSARY</b> .....	28
<b>XI. PRECAUTIONS</b> .....	31
<b>XII. SPECIFICATIONS</b> .....	32

# I. INTRODUCTION

Congratulations on your purchase of this Acura Security System. Your Acura Security System is the product of years of research and development. It will give you many years of reliable performance, protection, and convenience.

The system consists of two major components : a main unit and a remote control transmitter.

The main unit, located under the driver's seat, is the "brain" of the system. The built-in programmable microprocessor monitors your vehicle for optimal protection while offering various options to tailor the system to the preferences of different users.

The pocket sized remote control allows you to turn the system on and off from outside the vehicle while simultaneously locking and unlocking the doors\*. The transmitter can also be used to activate the horn or optional siren Intentionally in case of an emergency.

To take full advantage of your Acura Security System, we encourage you to read this manual thoroughly.

---

\* For vehicles equipped with power door locks.

Due to the expertise required to properly install the Acura Security System, we highly recommend that the installation be performed by you Acura dealer. Proper wiring and component placement are essential for optimum system performance.

These devices comply with Part 15 of the FCC Rules. Operation is subject to the following two conditions : (1) These devices may not cause harmful interference, and (2) these devices must accept any interference received, including interference that may cause undesired operation.

---

\* For vehicles equipped with power door locks.

## II. FEATURES

### PROTECTION FEATURES

- Door and trunk protection
- Ignition key switch protection
- Glass breakage protection (adjustable sensitivity)
- Main unit slide switch protection
- Starter disable
- Parking light flash
- Automatic rearm (upon completion of alarm cycle)
- Status LED
- Over one million security code combinations
- Sensor cancel
- Tripped sensor warning
- Tripped sensor indication
- Tripped sensor recall
- Optional sensor input (optional)

### CONVENIENCE FEATURES

- Three-button remote control transmitter
- Remote control arming/disarming
- Remote control chirp disable
- Remote control door lock/unlock\*
- Remote control panic activation
- Disarm/Valet switch
- Two car operation
- Extended exit arming

### PROGRAMMABLE FEATURES

- Selectable manual/automatic (passive)/auto lock arming modes
- Selectable horn/siren output (Duration 30/60 seconds)
- Selectable relock off/on

**NOTE :** The underlined modes denote factory settings.

\* For vehicles equipped with power door locks.

## III. REMOTE CONTROL TRANSMITTER

### 1. Controls

#### ① SILENT/PANIC BUTTON

*When used alone, this button controls the following :*

- Arms/Disarms the security system in Car #1 with no horn/siren chirps. When the system is armed/disarmed, the doors will also lock/unlock\*.
- Places the security system in Car #1 into a panic mode when this button is held for more than two seconds.

#### ② OPTION BUTTON

*When this button is pressed simultaneously with button 1, the following will occur :*

- The security system in Car #2 will arm/disarm with no horn/siren chirps. When the system is armed/disarmed, the doors will also lock/unlock\*.
- When both buttons are held for more than two seconds, the security system in Car #2 will enter a panic mode.

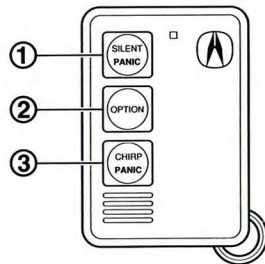

\* For vehicles equipped with power door locks.



When this button is pressed simultaneously with button 3, the following will occur :

- The security system in Car #2 will arm/disarm with horn/siren chirps. When the system is armed/disarmed, the doors will also lock/unlock\*.
- When both buttons are held for more than two seconds, the security system in Car #2 will enter a panic mode.

### ③ CHIRP/PANIC BUTTON

When used alone, this button controls the following :  
Arms/Disarms the security system in Car #1 with horn/siren chirps. When the system is armed/disarmed, the doors will also lock/unlock\*.

Places the security system in Car #1 into a panic mode when this button is held for more than two seconds.

## 2. Signal Indicator LED

- Illuminates when the remote control is transmitting a control signal.
- Indicates the remote control's battery condition. If the intensity (brightness) of the LED has decreased (dimmed), the battery should be replaced.

\* For vehicles equipped with power door locks.

## 3. Battery Replacement

1. Place the remote control on a flat surface with the buttons facing downward. Remove the battery case screws using a Phillips screwdriver.
2. While holding the remote control with the buttons facing upward, remove the top cover by gently lifting it towards you. (Do not pry!)
3. Remove the old battery and insert a new Lithium battery (#CR2025). Make sure the battery polarity is correct.
4. Replace the top cover by inserting the tabs on the upper end of the top cover into the lower cover.
5. Tighten the screws.

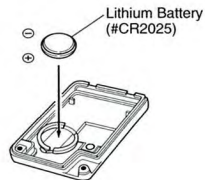
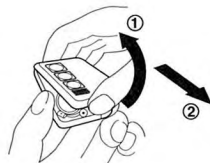
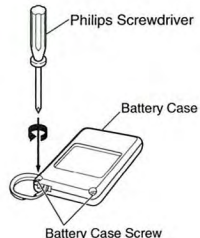

## IV. SYSTEM CONTROLS

### 4. Precautions

1. Never submerge the remote control transmitter in water.
2. Avoid exposing the remote control transmitter to extreme hot or cold weather conditions.
3. The remote control transmitter is a sophisticated electronic device. To maintain optimum system performance, avoid mishandling of the remote control (i.e. dropping, throwing).
4. If a remote control transmitter is ever lost, contact your local Acura dealer for a replacement. Your system will be reprogrammed to prevent the lost remote control transmitter from operating your system.
5. Use the remote control transmitter only when necessary. Every time a button is pressed, the remote control is consuming battery power.
6. The ring on the remote control transmitter is designed to attach the transmitter to the main key ring. To avoid damage to the transmitter, do not use this ring as the key ring to hold all keys.

### 1. Control Panel

The control panel, which is located on the face of the main unit, allows the following three features to be changed from factory settings.

#### **Horn/Siren (Duration)**

- Horn (30) : The audible alarm signal will come from the horn. The alarm duration cycle is also set to 30 seconds.
- Siren (60) : The audible alarm signal will come from the optional siren. The alarm duration cycle is also set to 60 seconds.

#### **NOTE :**

Make sure that the Horn/Siren switch corresponds to the proper audible alarming device. If the switch is not set properly, the audible signal will not be emitted when the alarm is tripped.

#### **Mode (Manual/Auto/Auto Lock)**

- Manual : The mode in which the system is armed using the remote control transmitter.
- Auto : The mode in which the system arms automatically when the last door is closed after the ignition is turned off and the ignition key is removed. The doors will not lock when the system arms automatically.

---

\* For vehicles equipped with power door locks.

**Auto Lock :** The mode in which the system arms automatically when the last door is closed after the ignition is turned off and the ignition key is removed. The doors will lock\* when the system arms automatically.

### **Relock (Off/On)**

- Off :** The doors will not relock and the system will not rearm 20 seconds after the system is disarmed by the remote control transmitter.
- On :** The doors will relock\* and the system will rearm 20 seconds after the system is disarmed by the remote control transmitter.
- If one of the following conditions occurs within 20 seconds after the system is disarmed, the relock feature will be disabled.
- One of the doors is opened.
  - The trunk is opened.
  - The hood is opened (if equipped with a hood switch).

### **NOTE :**

1. The previous features must be changed when the security system is in the Disarm mode. If the switches on the control panel are changed when the system is armed, the alarm will be triggered immediately.
2. The underlined modes denote factory settings. Consult your Acura dealer if you would like to change these features.

## **2. Disarm/Valet Switch**

The disarm/valet switch is used to control the following three functions :

- Disarm the system.
- Place the system in the Valet Mode.
- Activate the Tripped Sensor Re-Indication and Sensor Recall features.

For more specific operating procedures, please refer to the following sections.

## **3. Glass Breakage Detector**

The Glass Breakage Detector is a microphone which detects the sound of breaking glass. When the sensor detects a sound similar to that of breaking glass, the system will be triggered immediately. Please consult your local Acura dealer if adjustment of the Glass Breakage Detector is necessary.

---

\* For vehicles equipped with power door locks.

## V. ARMING

### 4. Glass Breakage Detector Sensitivity Control

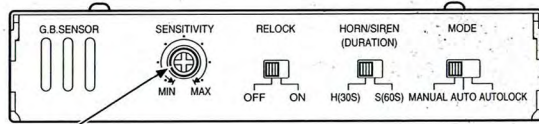

Glass Breakage Detector Sensitivity Adjustment (Main Unit)

The Glass Breakage Detector Sensitivity Control is located on the face of the main unit. The sensitivity is preset at the factory; however, if adjustment is necessary, please consult your local Acura dealer.

#### NOTE :

If the sensitivity is too low, the Glass Breakage Detector may not be able to detect the sound of breaking glass. If the sensitivity is too high, the Glass Breakage Detector may cause false alarms. Therefore, it is highly recommended that the sensitivity be adjusted by your local Acura dealer.

There are three possible ways to arm the system :

- Manual (Remote Controlled) Arming
- Automatic (Passive) Arming
- Auto Lock Arming

### 1. Manual (Remote Controlled) Arming

When the main unit is set to the manual arming mode, the system is armed and disarmed through the remote control transmitter. The system is set to this mode at the factory.

#### To Arm Car #1

1. Remove the key from the ignition.
2. Exit from the vehicle and close all the doors and the trunk.
3. Press the "Silent/Panic" button on the remote control transmitter to arm the system with no arming "chirp" or press the "Chirp/Panic" button on the remote control transmitter to arm the system with an arming "chirp". (The remote control LED will illuminate.)
4. The system will arm and the doors will lock.\*

#### To Arm Car #2

1. Remove the key from the ignition.
2. Exit from the vehicle and close all the doors and the trunk.

\* For vehicles equipped with power door locks.



3. Press the "Option" button simultaneously with the "Silent/Panic" on the remote control transmitter to arm the system with no arming "chirp" or press the "Option" button simultaneously with the "Chirp/Panic" button on the remote control transmitter to arm the system with an arming "chirp". (The remote control LED will illuminate.)
4. The system will arm and the doors will lock.\*

## 2. Automatic (Passive) Arming

When the main unit is set to the automatic (passive) arming mode, the system is armed automatically after the last door is closed. The system can be changed to this mode by sliding the mode switch on the control panel of the main unit to the Auto position.

### To Arm the System Automatically

1. Turn the ignition off.
2. Remove the key from the ignition.
3. Exit from the vehicle and close and lock all the doors and the trunk.
4. The system will arm after the last door is closed and the 20 second exit delay time has expired.

---

\* For vehicles equipped with power door locks.

### NOTE :

1. If the system is in the Automatic Arming mode and a door or trunk is opened during the 20 second exit delay time, the timer will reset itself and restart the count down procedure when the door or trunk is closed.
2. The remote control can still be used to arm the system when the system is in the automatic (passive) arming mode.

## 3. Auto Lock Arming

When the system is set to the auto lock arming mode, the system will arm automatically after the last door is closed. However, unlike the automatic (passive) arming mode, the doors will simultaneously lock\* when the system is armed. The system can be set to this mode by sliding the mode switch on the control panel of the main unit to the Auto Lock position.

### To Arm the System in the Auto Lock Arming Mode

1. Turn the ignition off.
2. Remove the key from the ignition.
3. Exit from the vehicle and close all the doors and the trunk.
4. The system will arm and the doors will lock\* after the last door is closed and the 20 second exit delay time has expired.

---

\* For vehicles equipped with power door locks.

**NOTE :**

1. If the system is in the Auto Lock Arming mode and a door or trunk is opened during the 20 second exit delay time, the timer will reset itself and restart the count down procedure when the door or trunk is closed.
2. The remote control can still be used to arm the system when the system is in the auto lock arming mode.

**Arm Mode Indicators**

When the system is armed, regardless of the method used, the following will occur :

- The parking lights will flash once.
- The extension LED will flash once/second.

**Alarm Mode**

After the system is armed, the sound of breaking glass or the opening of any of the doors or the trunk will trigger the alarm. When the alarm is triggered, you will observe the following :

- The horn or optional siren will sound for one alarm duration (either 30 or 60 seconds depending on the audible alarming device).
- The parking lights will flash for one alarm duration.
- The extension LED will flash twice/second for one alarm duration.
- The starter will be disabled.

---

\* For vehicles equipped with power door locks.

At the end of the alarm duration cycle, the system will automatically rearm.

**NOTE :**

If the battery is disconnected when the system is in the Arm or Alarm modes, any attempt to reconnect the battery will send the security system into the Alarm mode.

## VI. DISARMING

**There are two possible ways to disarm the system :**

- Remote Controlled Disarming
- Disarm/Valet Switch Disarming

### 1. Remote Controlled Disarming

Regardless of the method used to arm the system, the system can be disarmed using the remote control transmitter. The system can be disarmed with or without verification "chirps" depending on which buttons are pressed on the remote control.

#### To Disarm Car #1

1. Press the "Silent/Panic" button on the remote control transmitter to disarm the system with no arming "chirps" or press the "Chirp/Panic" button on the remote control transmitter to disarm the system with arming "chirps". (The remote control LED will illuminate.)
2. The system will disarm and the doors will unlock.\*

---

\* For vehicles equipped with power door locks.

#### To Disarm Car #2

1. Press the "Option" button simultaneously with the "Silent/Panic" on the remote control transmitter to disarm the system with no arming "chirps" or press the "Option" button simultaneously with the "Chirp/Panic" button on the remote control transmitter to disarm the system with arming "chirps". (The remote control LED will illuminate.)
2. The system will disarm and the doors will lock.\*

#### Remote Control Disarm Mode Indicators

When the system is disarmed by the remote control transmitter, the following will occur :

- The horn or optional siren will chirp twice (if the system is disarmed using the "Chirp/Panic" button on the remote control transmitter).
- The parking lights will flash twice.

#### NOTE :

If the relock switch on the control panel of the main unit is turned on, the system will rearm (with no "chirp") and relock the doors 20 seconds after the system is disarmed if the doors, trunk, or hood are not opened.

---

\* For vehicles equipped with power door locks.

## 2. Disarm/Valet Switch Disarming

Like remote controlled disarming, the system can be disarmed using the Disarm/Valet Switch regardless of the method used to arm the system. This method of disarming also serves as an emergency override if the remote control transmitter is lost or becomes inoperative.

### To Disarm the System Using the Disarm/Valet Switch

1. Enter the vehicle.
2. Insert the ignition key.
3. Turn the ignition on.
4. Press the Disarm/Valet switch button.

#### NOTE :

When the system is armed automatically (passively), the user is allowed a 20 second entry delay time to disarm the system once the door is opened. However, when the system is armed by the remote control transmitter, the entry delay time is changed to zero seconds, with the alarm being triggered immediately once the door is opened. Regardless of whether the system is armed or alarming, the Disarm/Valet Switch can be used to disarm the system.

## VII. PANIC

The horn or optional siren can be Intentionally activated by the remote control transmitter. This is a convenient feature if you need to attract attention in case of an emergency.

### To Activate the Panic Function on Car #1

1. Press and hold either the "Silent/Panic" or "Chirp/Panic" button for two seconds.
2. The horn or optional siren will sound and the parking lights will flash for one alarm duration cycle.

### To Activate the Panic Function on Car #2

1. Press and hold the "Option" button simultaneously with either the "Silent/Panic" or "Chirp/Panic" button for two seconds.
2. The horn or optional siren will sound and the parking lights will flash for one alarm duration cycle.

### To Deactivate the Panic Function on Car #1

1. Press either the "Silent/Panic" or "Chirp/Panic" button.

### To Deactivate the Panic Function on Car #2

1. Press the "Option" button simultaneously with either the "Silent/Panic" or "Chirp/Panic" button.



## VIII. VALET

When the security system is placed in valet, it is temporarily placed on "hold". When in the valet mode, the system cannot be armed, but can still be panicked. This is a convenient feature if the car is to be washed, serviced, or valet parked.

### To Place the System in the Valet Mode

1. Disarm the system.
2. With the key out of the ignition, press and hold the Disarm/Valet switch on for three seconds.
3. The extension LED will flash once, indicating that the system is in the Valet mode.

#### NOTE :

If a door is opened or the ignition is turned off while the system is in the valet mode, the extension LED will illuminate for two seconds as a reminder that the system is in the valet mode.

### To Exit from the Valet Mode

1. With the system in the Valet mode and the key out of the ignition, press and hold the Disarm/Valet switch for one second.
2. The extension LED will flash twice, indicating that the system is out of the Valet mode.
3. The system is now in the Disarm mode.

## IX. TRIPPED SENSOR WARNING & INDICATION

The security system incorporates two methods of notifying you if the security system is tripped in your absence.

### 1. Tripped Sensor Warning

The system will warn you that the security system has been tripped in your absence by :

- "Chirping" the horn or optional siren three times when the system is disarmed by the remote control transmitter (if the "Chirp/Panic" button is used to disarm the system).
- Flashing the parking lights three times when the system is disarmed by the remote control transmitter.
- Blinking the extension LED twice/second before the system is disarmed.

### 2. Tripped Sensor Indication

The system will indicate the sensor which caused the alarm to be triggered through the extension LED. When the system is disarmed by the remote control transmitter, the extension LED will blink according to the following code :

## SENSORS

Door  
Trunk  
Glass Breakage  
Optional  
Hood  
System Switches

## NUMBER OF FLASHES

1 blink, pause, repeat  
2 blinks, pause, repeat  
3 blinks, pause, repeat  
4 blinks, pause, repeat  
5 blinks, pause, repeat  
6 blinks, pause, repeat

### **Example 1 :**

If opening the trunk causes the alarm to be triggered, the LED will blink two times, pause, and repeat this sequence for one minute.

### **Example 2 :**

If the alarm is triggered twice, first by the glass breakage detector and then by the opening of the door, the Extension LED will blink three times, pause, blink once, pause, and repeat this sequence for one minute.

### **NOTE :**

The tripped sensor indication feature will be disabled when :

- the one minute time period has elapsed
- the ignition is turned on
- the system is rearmed

### **3. Tripped Sensor Re-indication**

If the extension LED indication of the last tripped sensor was missed when the system was disarmed, the following procedure will display the tripped sensor.

1. With the system in the disarm mode, quickly push the Disarm/Valet switch three times within five seconds.
2. The extension LED will display the last tripped sensor.

### **NOTE :**

The Tripped Sensor Re-indication feature will be disabled once the system is rearmed.

### **4. Tripped Sensor Recall**

As a diagnostic tool, the last tripped sensor can be recalled from memory regardless of whether the system had been rearmed or the ignition turned on. To recall the last tripped sensor :

1. Sit inside the vehicle.
2. Arm the system.
3. While holding the Disarm/Valet switch on, disarm the system.
4. The extension LED will indicate the last tripped sensor.

## X. GLOSSARY

**ALARM DURATION :** The amount of time the horn or optional siren sounds when the alarm is tripped or the panic feature is activated. The duration is selectable between 30 and 60 seconds.

**ARM :** To turn the security system's protection on.

**AUTO LOCK ARMING :** The optional mode in which the security system is armed automatically (passively) after the trunk and all the doors are closed. At the same time the system arms, the doors also lock.

**AUTOMATIC ARMING :** The optional mode in which the security system is armed automatically (passively) after the trunk and all the doors are closed. The doors do not lock when the system is armed.

**DISARM :** To turn the security system's protection off.

**ENTRY DELAY TIME :** The amount of time before the alarm is triggered after the door is opened.

**EXIT DELAY TIME :** When the system is set to the Automatic or Auto Lock Arming positions, the amount of time before the system arms after the trunk and all the doors are closed.

**EXTENDED EXIT ARMING :** If a door or trunk is opened during the exit delay time, the timer will reset itself and will restart the count down procedure when that door or trunk is closed.

**MANUAL (REMOTE CONTROLLED) ARMING :** The mode in which the system is armed and disarmed by the remote control transmitter. This is the factory preset mode.

**PANIC :** A mode in which the horn or optional siren are intentionally activated. Useful for attracting attention in case of an emergency.

**RELOCK :** A selectable feature where the system rearms itself and locks the doors 20 seconds after being disarmed by the remote control transmitter. This feature is disabled if any of the doors, the trunk, or hood is opened during the 20 second time period.

**SENSOR CANCELLATION :** A feature which cancels (ignores) a particular sensor which has caused the alarm to be tripped consecutively for 10 minutes.

**TRIPPED SENSOR INDICATION :** A feature which indicates, through the extension LED, the sensor which tripped the alarm when the system is disarmed. This indication only occurs when the system is disarmed by the remote control transmitter.

**TRIPPED SENSOR RECALL** : A diagnostic feature which recalls the last tripped sensor from memory. This feature is not disabled once the alarm is rearmed.

**TRIPPED SENSOR RE-INDICATION** : A feature which displays the last tripped sensor if the original tripped sensor indication was missed. This feature is disabled once the alarm is rearmed.

**TRIPPED SENSOR WARNING** : A feature which tells the owner that the alarm was tripped in his/her absence.

**TWO CAR OPERATION** : A mode in which one remote control transmitter can control security systems in two separate vehicles.

**VALET** : A mode in which the system cannot be armed. Useful when the car is being serviced, valet parked, or washed.

## XI. PRECAUTIONS

### REMOTE CONTROL RANGE

Several factors affect and reduce remote control range. Among these are :

1. Proximity to buildings and automobiles.
2. Proximity to high power transmitters (television, radio, cellular, HAM radio, etc.)

Vehicle construction and the surrounding environment cause reflected waves which may interfere with the low power RF signal transmitted by the remote control. This interference may result in "dead spots" around the vehicle from where remote control signals will not be accepted by the main unit.



## XII. SPECIFICATIONS

### Main Unit

Design.....	Microprocessor, all solid state
Operating Voltage.....	13V DC (9V to 16V allowable)
Current Consumption (Arming).....	7mA
Output Type/Maximum Current	
Starter Cut.....	0.1A
Door lock/Unlock.....	0.1A
Operating Temperature.....	-40°C to +80°C
Dimensions.....	120mm×110mm×25mm
Net Weight.....	0.33kg

### Remote Control Transmitter

Transmitter Type.....	Radio frequency
Range.....	Average 50 Feet
Battery Type.....	Lithium (# CR2025)
Battery Life.....	1 Year (Typical)
Operating Temperature.....	-20°C to +75°C
Dimensions.....	40mm×58mm×9mm
Net Weight.....	21g

For Product improvement, specifications and design are subject to change without notice.

# ACURA

08E51-ST7-2M00-82  
68P50390W38-O  
Printed in Japan

©American Honda Motor Co., Inc. 1993 All Rights Reserved.