



Throttle Body Cleaning

SYMPTOM

When the engine is first started after the vehicle has sat overnight, customers may “feel” the release of the throttle plate through the accelerator pedal. Some describe it as a one-time “pop” sensation.

Customers may have trouble explaining this phenomenon because

- They can't repeat it because it only happens one time, when the engine is cold.
- The accelerator pedal works normally at all other times.
- There are no other symptoms.
- It may be intermittent, happening only during cooler weather.

PROBABLE CAUSE

The symptom is caused by normal buildup of contaminants in the throttle bore, combined with expansion and contraction of the throttle body.

CORRECTIVE ACTION

Partially remove the throttle body, and clean it with Honda carburetor cleaner or throttle plate and induction cleaner.

WARRANTY CLAIM INFORMATION

In warranty: The normal warranty applies.

OP #	Description	FRT	Template ID
121008	Clean throttle body, and reuse throttle body gasket	0.6	01-004A
121008	Clean throttle body, and replace throttle body gasket	0.6	01-004B

Failed Part: P/N 16400-PAA-A61
H/C 5429006

Defect Code: 030

Contention Code: B99

Skill Level: Repair Technician

Out of warranty: Any repair performed after warranty expiration may be eligible for goodwill consideration by the District Service Manager or your Zone Office. You must request consideration, and get a decision, before starting work.

PARTS INFORMATION

Throttle Body Gasket (used only if needed):
P/N 16176-PAA-A01, H/C 5428966

REQUIRED MATERIALS

Carburetor Cleaner:
P/N 08732-0006, H/C 4713673

or

Throttle Plate and Induction Cleaner:
P/N 08732-9009, H/C 6204945

REPAIR PROCEDURE

1. Remove the breather tube from the air intake duct, unclip the vacuum lines from the duct, and remove the duct from the throttle body.

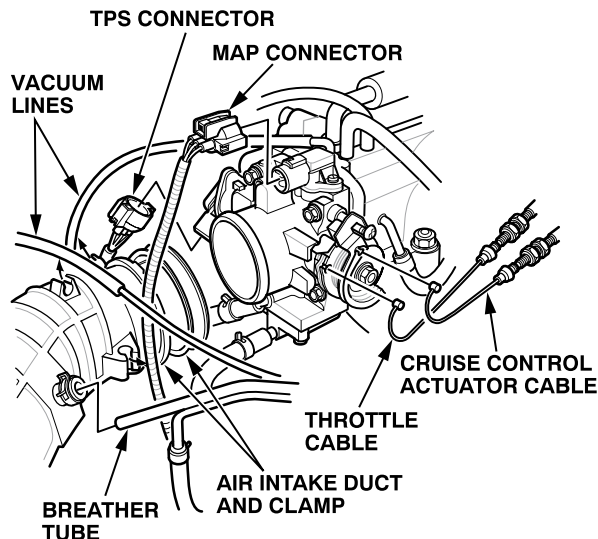

2. Disconnect the TPS and MAP connectors from the throttle body.
3. Remove the throttle cable and, if equipped, the cruise control actuator cable from the throttle body.



- Remove the throttle body mounting nuts and bolts, then slide the throttle body off its studs on the intake manifold chamber. Leave the coolant hoses connected.

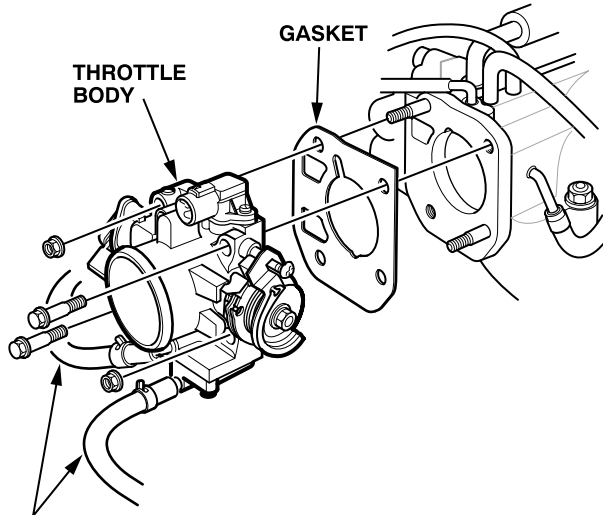

Leave the coolant hoses connected.

- Put a shop towel under the throttle body, open the throttle, then clean out any contaminants from the intake manifold side of the throttle body with carburetor cleaner or throttle plate and induction cleaner.

NOTE: To avoid damaging the idle air control valve (IACV), spray the cleaner through the back of the throttle body, not the front.

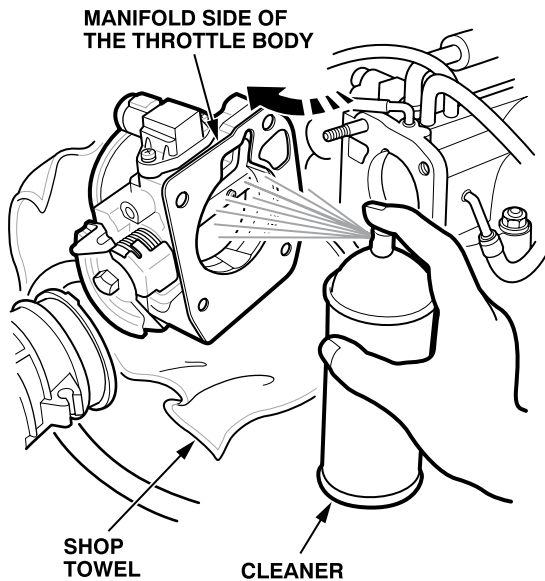

- Check the throttle body gasket for damage, and use a new one if needed.
- Reinstall all parts in reverse order of removal. Torque the throttle body nuts and bolts to 22 N·m (16 lb-ft).

- Adjust the cruise control actuator cable (see page 4-55 of the 1998-01 Accord L4 Service Manual).
- Adjust the throttle cable (see page 11-132).
- Make sure the accelerator pedal works normally, and check that all hoses and cables are routed correctly.