

Automotive Data Solutions Inc.

INSTALL GUIDE

HA3

ADS-AL(DL)-HA3-EN

AVAILABLE FOR: ADS-AL CA

Rev. Date: November 18, 2014

Doc. No.: ##17751##

U.S. PATENT NO. 8,856,780

PLEASE VISIT WWW.IDATALINK.COM FOR COMPLETE PRODUCT DETAILS

The brand names and logos found in this guide are property of their respective owners. Automotive Data Solutions Inc. © 2014

ACURA

HONDA

NOTICE: The manufacturer will accept no responsibility for any electrical damage resulting from improper installation of this product, be that either damage to the vehicle itself or to the installed device. This device must be installed by a certified technician. This guide has been written for properly trained technicians; a certain level of skill & knowledge is therefore assumed. Please review the Installation Guide carefully before beginning any work.

INSTALL TYPE SELECTION

MAKE	MODEL	YEAR	INSTALL TYPE	FEATURES														
				DATA IMMOBILIZER BYPASS	ARM OEM ALARM	DISARM OEM ALARM	DOOR LOCK	DOOR UNLOCK	TRUNK/HATCH RELEASE*	POWER LIFTGATE*	POWER SLIDING DOOR (L)*	POWER SLIDING DOOR (R)*	DOOR STATUS OUTPUT	TRUNK STATUS OUTPUT	HOOD STATUS OUTPUT	TACHOMETER OUTPUT	E-BRAKE OUTPUT	BRAKE PEDAL STATUS OUTPUT
ACURA	TL STD key	09-14	1	•	•	•	•	•	•				•	•	•	•	•	•
	TSX STD key	09-13	1	•	•	•	•	•	•				•	•	•	•	•	•
	ZDX STD key	10-11	1	•	•	•	•	•	•				•	•	•	•	•	•
HONDA	Accord STD key	08-12	1	•	•	•	•	•	•				•	•	•	•	•	•
	Accord Crosstour STD key	10-12	1	•	•	•	•	•	•				•	•	•	•	•	•
	Civic STD key	12-15	2	•	•	•	•	•	•				•	•	•	•	•	•
	Civic Hybrid STD key	12-13	2	•	•	•	•	•	•				•	•	•	•	•	•
	CR-V STD key	12-15	2	•	•	•	•	•	•				•	•	•	•	•	•
	Odyssey STD key	11-13	1	•	•	•	•	•		•	•	•	•	•	•	•	•	•
	Odyssey STD key	14	1	•	•	•	•	•					•	•	•	•	•	•
	Pilot STD key	09-15	1	•	•	•	•	•		•			•	•	•	•	•	•

* When vehicle is remote started, feature will not be functional.
 Use traditional hardwired installation method for feature to be functional during remote start.

WARNING: READ CAREFULLY

IMPORTANT

- I Ground When Running from Remote Starter must be provided BEFORE Ignition.
Failure to comply may result in immobilizer bypass malfunction during remote start.
- II If Ground When Running from Remote Starter CAN'T be provided BEFORE Ignition, use a separate TB-HA for immobilizer bypass ONLY.
- III
 - DO NOT program unlock before start on the Remote Starter.
 - DO NOT change Remote Starter OEM alarm control default settings.Failure to comply may result in product malfunction.

TYPE 1 - WIRE CROSS REFERENCE CHART

MAKE	MODEL	YEAR	WIRE DESCRIPTION	CONNECTOR NAME	CONNECTOR COLOR	CONNECTOR TYPE	POSITION	WIRE COLOR	POLARITY	MODULE LOCATION	COMPONENT LOCATOR
ACURA	TL STD key	09-14	Ignition	~	White	7 pin	2	Yellow	(+)	At immobilizer	~
			Key Data	~	White	7 pin	6	LtGreen	(DATA)	At immobilizer	~
			CanH	~	White	7 pin	4	Pink	(DATA)	At immobilizer	~
			CanL	~	White	7 pin	3	Blue	(DATA)	At immobilizer	~
	TSX STD key	09-13	Ignition	~	White	7 pin	2	Yellow	(+)	At immobilizer	~
			Key Data	~	White	7 pin	6	LtGreen	(DATA)	At immobilizer	~
			CanH	~	White	7 pin	4	Pink	(DATA)	At immobilizer	~
			CanL	~	White	7 pin	3	Blue	(DATA)	At immobilizer	~
	ZDX STD key	10-11	Ignition	~	White	7 pin	2	Yellow	(+)	At immobilizer	~
			Key Data	~	White	7 pin	6	LtGreen	(DATA)	At immobilizer	~
			CanH	~	White	7 pin	4	Pink	(DATA)	At immobilizer	~
			CanL	~	White	7 pin	3	Blue	(DATA)	At immobilizer	~
HONDA	Accord STD key	08-12	Ignition	~	White	7 pin	2	Yellow	(+)	At immobilizer	~
			Key Data	~	White	7 pin	6	LtGreen	(DATA)	At immobilizer	~
			CanH	~	White	7 pin	4	Pink	(DATA)	At immobilizer	~
			CanL	~	White	7 pin	3	Blue	(DATA)	At immobilizer	~
	Accord Crosstour STD key	10-12	Ignition	~	White	7 pin	2	Yellow	(+)	At immobilizer	~
			Key Data	~	White	7 pin	6	LtGreen	(DATA)	At immobilizer	~
			CanH	~	White	7 pin	4	Pink	(DATA)	At immobilizer	~
			CanL	~	White	7 pin	3	Blue	(DATA)	At immobilizer	~
	Odyssey STD key	11-14	Ignition	~	White	7 pin	2	Yellow	(+)	At immobilizer	~
			Key Data	~	White	7 pin	6	Purple	(DATA)	At immobilizer	~
			CanH	~	White	7 pin	4	Pink	(DATA)	At immobilizer	~
			CanL	~	White	7 pin	3	Blue	(DATA)	At immobilizer	~
	Pilot STD key	09-15	Ignition	~	White	7 pin	2	Brown	(+)	At immobilizer	~
			Key Data	~	White	7 pin	6	Pink	(DATA)	At immobilizer	~
			CanH	~	White	7 pin	4	White	(DATA)	At immobilizer	~
			CanL	~	White	7 pin	3	LtGreen	(DATA)	At immobilizer	~

TYPE 1 - WIRING DIAGRAM

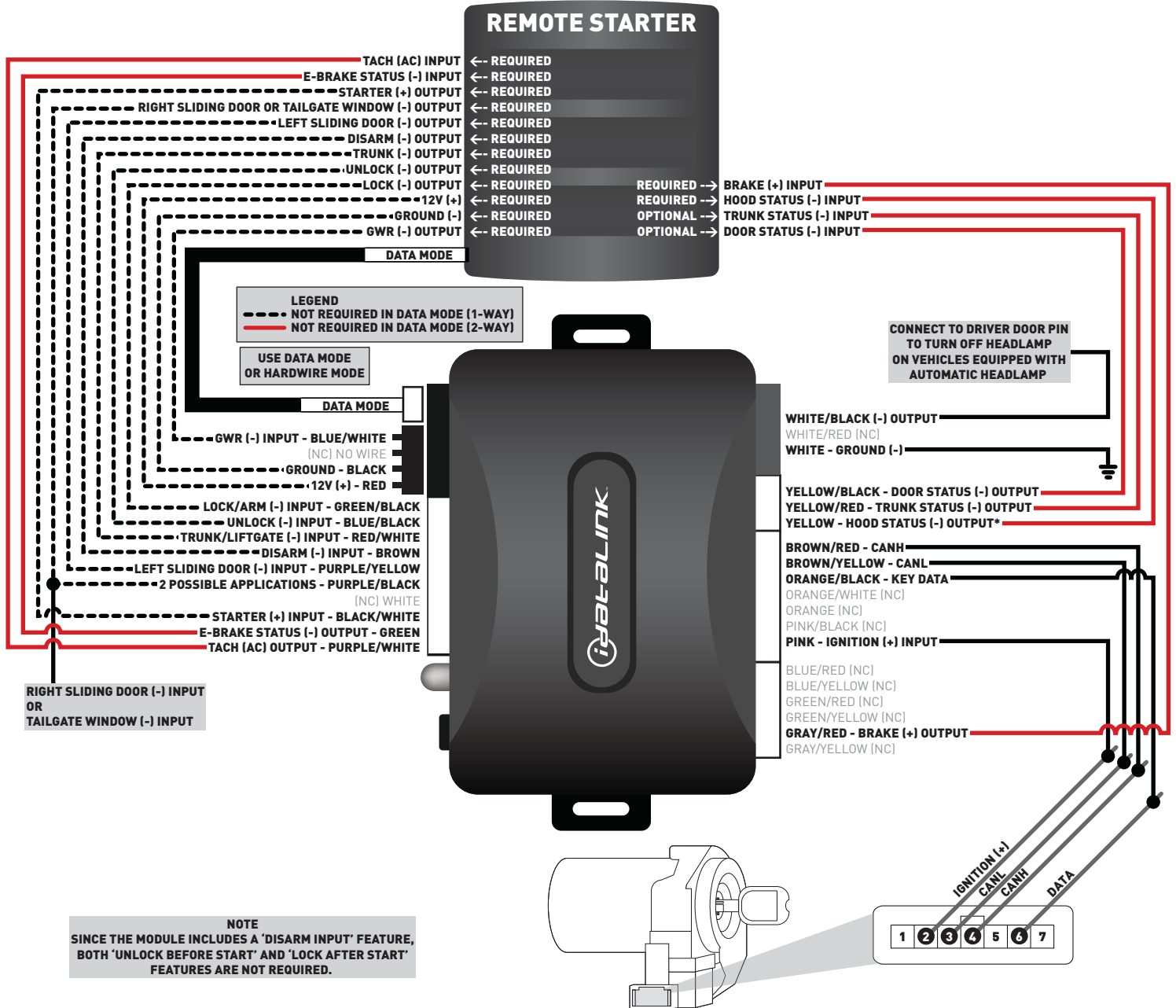

TYPE 2 - WIRE CROSS REFERENCE CHART

MAKE	MODEL	YEAR	WIRE DESCRIPTION	CONNECTOR NAME	CONNECTOR COLOR	CONNECTOR TYPE	POSITION	WIRE COLOR	POLARITY	MODULE LOCATION	COMPONENT LOCATOR
HONDA	Civic STD key	12-15	Ignition	~	White	7 pin	2	Yellow	(+)	Ignition switch	~
			CanH	~	White	7 pin	4	Pink	(DATA)	Ignition switch	~
			CanL	~	White	7 pin	3	Blue	(DATA)	Ignition switch	~
			Key Data	~	White	7 pin	6	LtGreen	(DATA)	Ignition switch	~
			Lock	~	~	~	~	Blue*	(-)	Driver door harness	~
			Unlock	~	~	~	~	Gray	(-)	Driver door harness	~
	Civic Hybrid STD key	12-13	Ignition	~	White	7 pin	2	Yellow	(+)	Ignition switch	~
			CanH	~	White	7 pin	4	Pink	(DATA)	Ignition switch	~
			CanL	~	White	7 pin	3	Blue	(DATA)	Ignition switch	~
			Key Data	~	White	7 pin	6	LtGreen	(DATA)	Ignition switch	~
			Lock	~	~	~	~	Blue*	(-)	Driver door harness	~
			Unlock	~	~	~	~	Gray	(-)	Driver door harness	~
	CR-V STD key	12-15	Ignition	~	White	7 pin	2	DkBlue	(+)	Ignition switch	~
			CanH	~	White	7 pin	4	Pink	(DATA)	Ignition switch	~
			CanL	~	White	7 pin	3	Blue	(DATA)	Ignition switch	~
			Key Data	~	White	7 pin	6	Yellow	(DATA)	Ignition switch	~
			Lock	~	~	~	~	Green	(-)	Driver door harness	~
			Unlock	~	~	~	~	Gray	(-)	Driver door harness	~

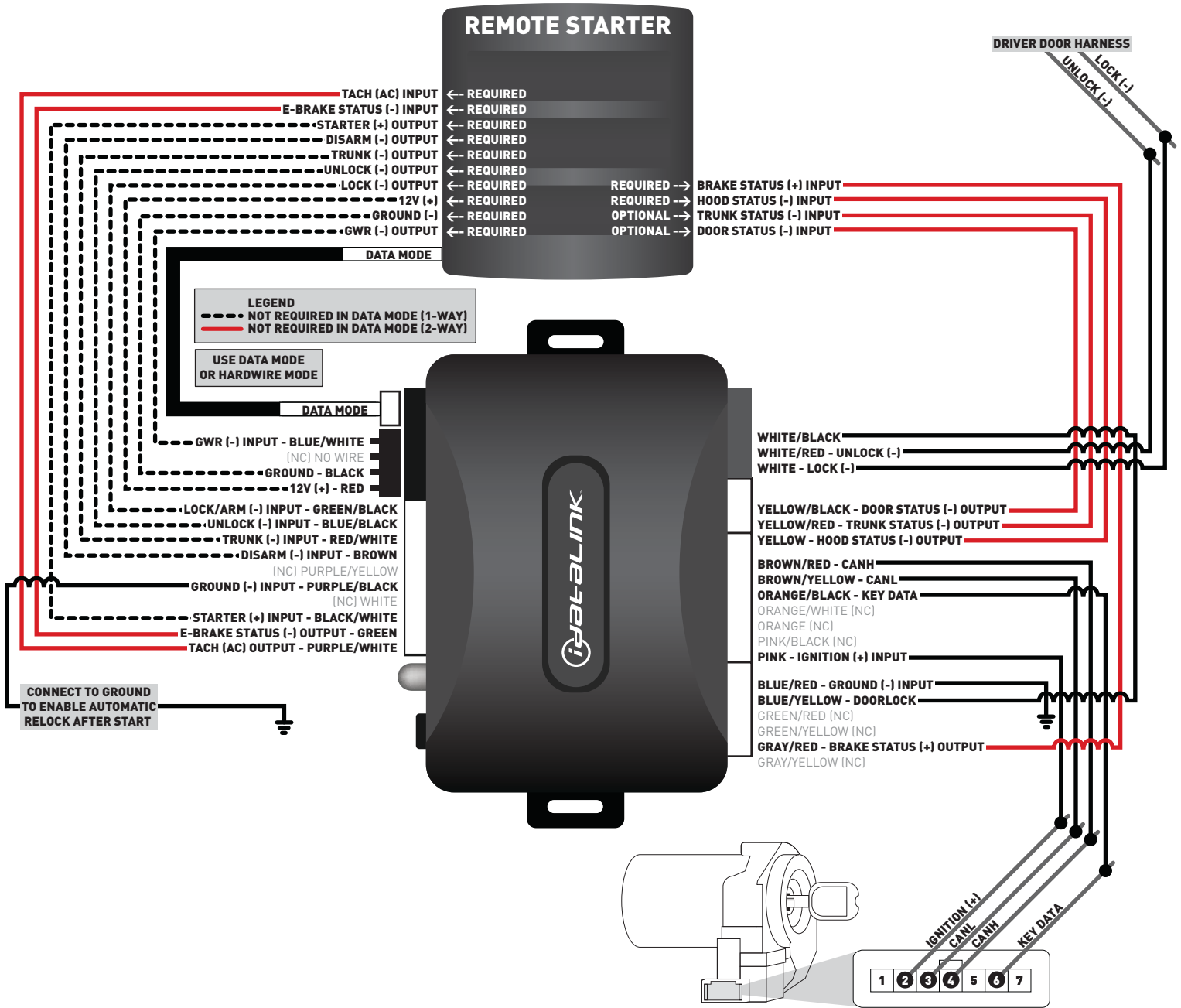

*WARNING: Failure to test this wire will damage the module. Wire gage may be smaller.

TYPE 2 - WIRING DIAGRAM

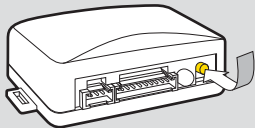

INSTALLATION MODE SELECTION

1  Press and release programming button to select installation mode.

 LED flashes (1X) once = DATA MODE
 LED flashes (2X) twice = STANDARD HARDWARE MODE

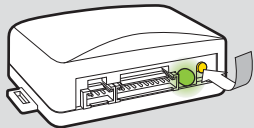
2  Press and hold programming button until LED turns solid GREEN to register selection.

! After registration, follow Factory Reset Procedure to change installation mode and restart this procedure.

MODULE PROGRAMMING PROCEDURE

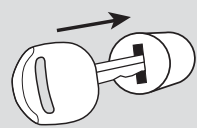
1  Insert key into ignition.

2  Turn key to ON position.

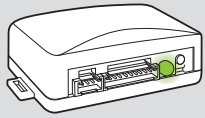
3  Wait, LED will turn solid GREEN for **2 seconds**.

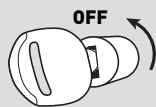
4  Turn key to OFF position.

5  Press UNLOCK on the OEM remote.

! If the vehicle is equipped with a power liftgate: Open and close the power liftgate with the OEM keyfob.

6 Module Programming Procedure completed.

IDENTIFY VEHICLE YEAR

1

Locate the Vehicle Identification Number (VIN) and identify the 10th character.



2

Match the VIN's 10th character to its corresponding year.

L → 1990	S → 1995	Y → 2000	5 → 2005	A → 2010
M → 1991	T → 1996	1 → 2001	6 → 2006	B → 2011
N → 1992	V → 1997	2 → 2002	7 → 2007	C → 2012
P → 1993	W → 1998	3 → 2003	8 → 2008	D → 2013
R → 1994	X → 1999	4 → 2004	9 → 2009	E → 2014

MODULE DIAGNOSTICS

LED STATUS	DIAGNOSTICS		
	DURING PROGRAMMING	DURING REMOTE START	WITH IGNITION OFF
Flashing RED	Missing/wrong information from firmware or vehicle	Incorrectly programmed	Incorrectly programmed or connected
Solid RED	Waiting for more vehicle information	Incorrectly programmed	Not programmed waiting for more vehicle information
Flashing GREEN	Additional steps required to complete programming	Correctly programmed and operational	False ground when running status from remote starter
Solid GREEN then OFF	Correctly programmed	Reset in progress	Reset in progress
OFF	No activity or already programmed	Invalid ground when running status from remote starter	At rest and ready for a remote start sequence

FACTORY RESET PROCEDURE

1

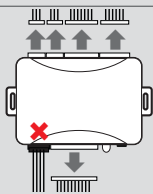

DISCONNECT all connectors from module **EXCEPT** the black 4-PIN standard or optional data connector.

2

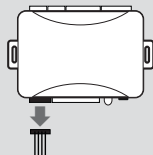

DISCONNECT black 4-PIN standard or optional data connector.

3

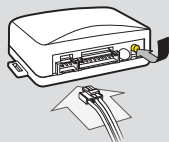

PRESS AND HOLD programming button while connecting either 4-PIN standard or optional data connector.

4

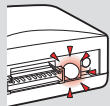

When LED flashes red, **RELEASE** programming button.

5

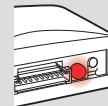

LED will turn solid red for 2 seconds.

RESET COMPLETED.

6

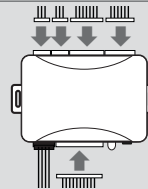

RECONNECT all connectors.

7

Repeat programming procedure.



Failure to follow procedure may result with a DTC or a CHECK ENGINE error message.